

ENTRY NO. CU92 Date September 1995
 Cyclotron Model TCC CS-30
 Institution NIH, Clinical Center
 Address 10/1C401, Bethesda, MD, 20892-1180
 Tel (301) 496-0345 Telex
 Fax (301) 402-3521 E-MAIL
 In Charge: W. Eckelman Reported by: P. Plaszcjak
 E-Mail: Paul@nmdhst.cc.nih.gov

HISTORY
 MILESTONE DATES: ACCEPTED
 Installation March 1985 First Beam March 1986
 DESIGN/CONSTRUCTION BY: The Cyclotron Corp.
 COST: Accelerator Facility
 FUNDED BY: National Institutes of Health

STATUS
 STAFF: Operators 3 Technicians 1
 BUDGET: Machine Funded by NIH
 TIME DISTRIBUTION: (e.g. basic research, isotope production, maintenance, etc.)
 (a) PET Isotope Production 95 %
 (b) Maintenance 5 %
 (c) %
 (d) %
 (e) %

CHARACTERISTIC BEAMS

Accelerated Ions	E/A (MeV/u)	Current (part μ A)	
		Internal	External
(a) H^{1+}, H^{2+}	26.5	200, 300	60, 100
(b) He^{3+}, He^{4+}		140, 100	60, 40

1994 μ A-hours on target: ~20k

FACILITIES

SHIELDED AREA: Fixed 90 m² Moveable 0 m²
 Target Stations: 8 No. Served At Same Time: 1
 OTHER FACILITIES: 6 Pos. Target Changer
 Internal Target
 Hot Cells

REFERENCES/NOTES

- (a) 11th International Conference on Cyclotrons and Their Applications, Ionics Publ., Tokyo 685-688, (1987)
- (b)

PLAN VIEW OF FACILITY, COMMENTS

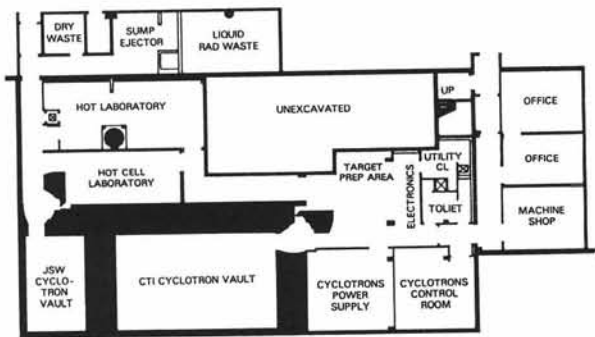

NIH CYCLOTRON FACILITY B-3 LEVEL

ENTRY NO. CU93 Date
 Cyclotron Model NEN Cyclotron 1
 Institution DuPont Merck Pharmaceutical Co.
 Address 331 Treble Cove Rd. Billerica, MA 01862
 Tel (508) 671-8012 Telex
 Fax EMAIL
 In Charge: Peter Holton Reported by: Frank Buck

HISTORY
 MILESTONE DATES:
 Installation 3/70 First Beam 7/70
 DESIGN/CONSTRUCTION BY: Cyclotron Corp. CS-22
 COST: Accelerator Facility
 FUNDED BY: E.I. DuPont

STATUS
 STAFF: Operators Technicians
 BUDGET: Machine Funded by
 TIME DISTRIBUTION: (e.g. basic research, isotope production, maintenance, etc.)
 (a) Isotope Production 100 %
 (b) %
 (c) %
 (d) %
 (e) %

CHARACTERISTIC BEAMS

Accelerated Ions	E/A (MeV/u)	Current(part μ A)	
		Internal	External
(a) Protons	22	200	
(b)			

1991 μ A-hours on target:

FACILITIES

SHIELDED AREA: Fixed 60 m² Moveable m²
 Target Stations: 1 No. Served At Same Time:
 OTHER FACILITIES:

REFERENCES/NOTES

- (a)
- (b)

PLAN VIEW OF FACILITY, COMMENTS